

252 Richmond Road Marleston SA

High exposure with easy parking close to CBD and Adelaide Airport

- ? 8 large offices - flexible to lease the full 300 sqms or portion 150 sqms
- ? Open work stations
- ? IT room
- ? Impressive reception area
- ? Large corporate boardroom
- ? Fully equipped kitchen with preparation area
- ? Male/Female WC
- ? Set on corner allotment Richmond Road and Sutton Terrace
- ? 8 carparks

Outstanding Building with quality and class - \$62,000-\$65,000 pa + outgoings

Price : \$65,000pa plus GST plus outgoings
Building Size : 248 sqm
View : <https://www.martinrealestate.com.au/lease/sa/western-beachside-suburbs/marleston/commercial/offices/7441385>



Colin Martin
08 8361 7111

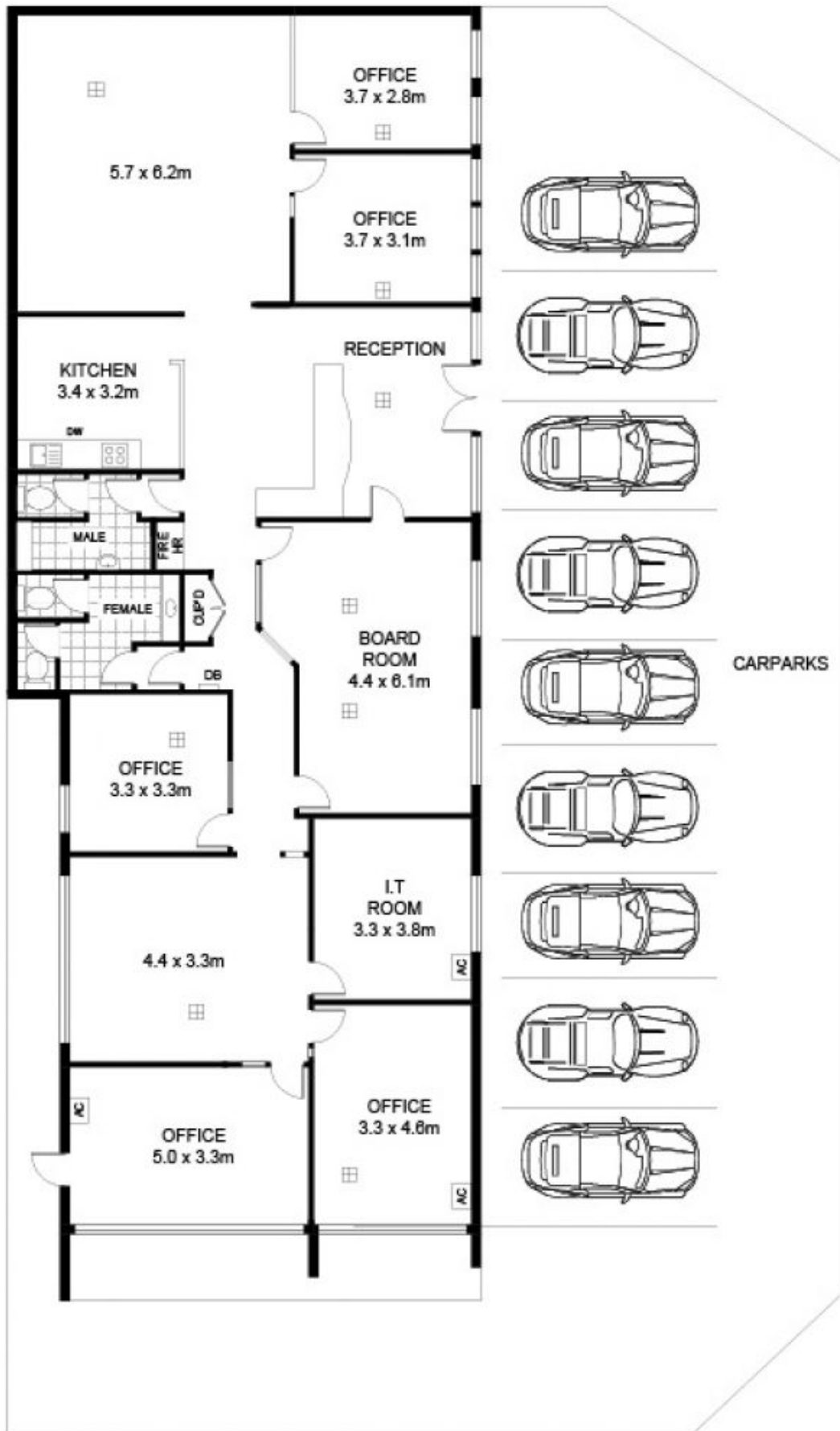

Scale in metres indicative only. Dimensions are approximate. All information contained herein is gathered from sources we believe to be reliable. However we cannot guarantee its accuracy and interested persons should rely on their own enquiries.

OFFICE/ AMEN: : 248m²

252 Richmond Road, Marlestone