



194a-196a Hutt Street Adelaide SA

Choose from 2 offices - 50 sqm each (approx)

Great space for retail use or professional offices.

Car parking is available directly at the front of the building making it easy for your clients.

Just the right location to be surrounded by an excellent mix of business, cafés and restaurants ...with a great community vibe!

Contact Colin Martin 0412 822 166

RLA 255581

Price : \$29,000 PA plus GST plus Outgoings
Building Size : 120 sqm
View : <https://www.martinrealestate.com.au/lease/sa/adelaide/adelaide/commercial/offices/7739145>



Colin Martin
08 8361 7111

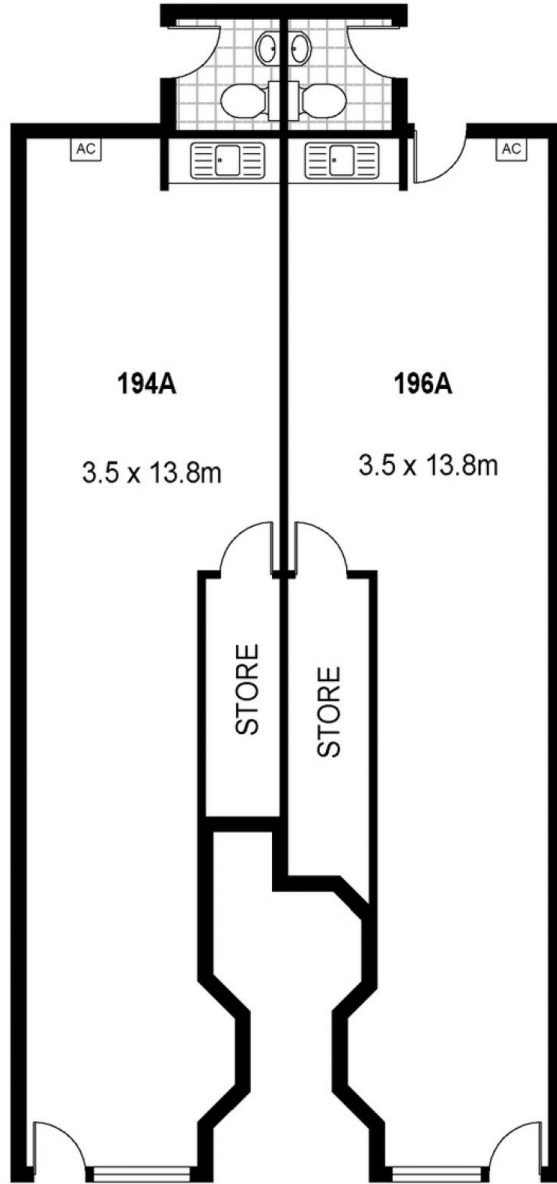

Scale in metres. Indicative only. Dimensions are approximate. All information contained herein is gathered from sources we believe to be reliable. However we cannot guarantee its accuracy and interested persons should rely on their own enquiries

194A : 48m²
196A : 52m²

194A Hutt Street, Adelaide