



2-8 Laverstock Road Elizabeth North SA

With approvals in place, development and design have been sorted.

Specialised street scape this opportunity consists of the proposed 110 placement Child Care Centre plus 2 units for assisted living under ideal NDIS.

What more could you want than this simple ideal development investment opportunity?

Proposed Plans available

Contact Colin Martin 0412 822 166 for more information. RLA 255581

- Price** : HIGHEST & BEST OFFER by 30th April 2024 (USP)
- Building Size** : 820 sqm
- Land Size** : 3660 sqm
- View** : <https://www.martinrealestate.com.au/sale/sa/north-north-east-suburbs/elizabeth-north/commercial/healthcare/7972285>



Colin Martin
08 8361 7111

PLANNING ISSUE

Rev Amendment Date

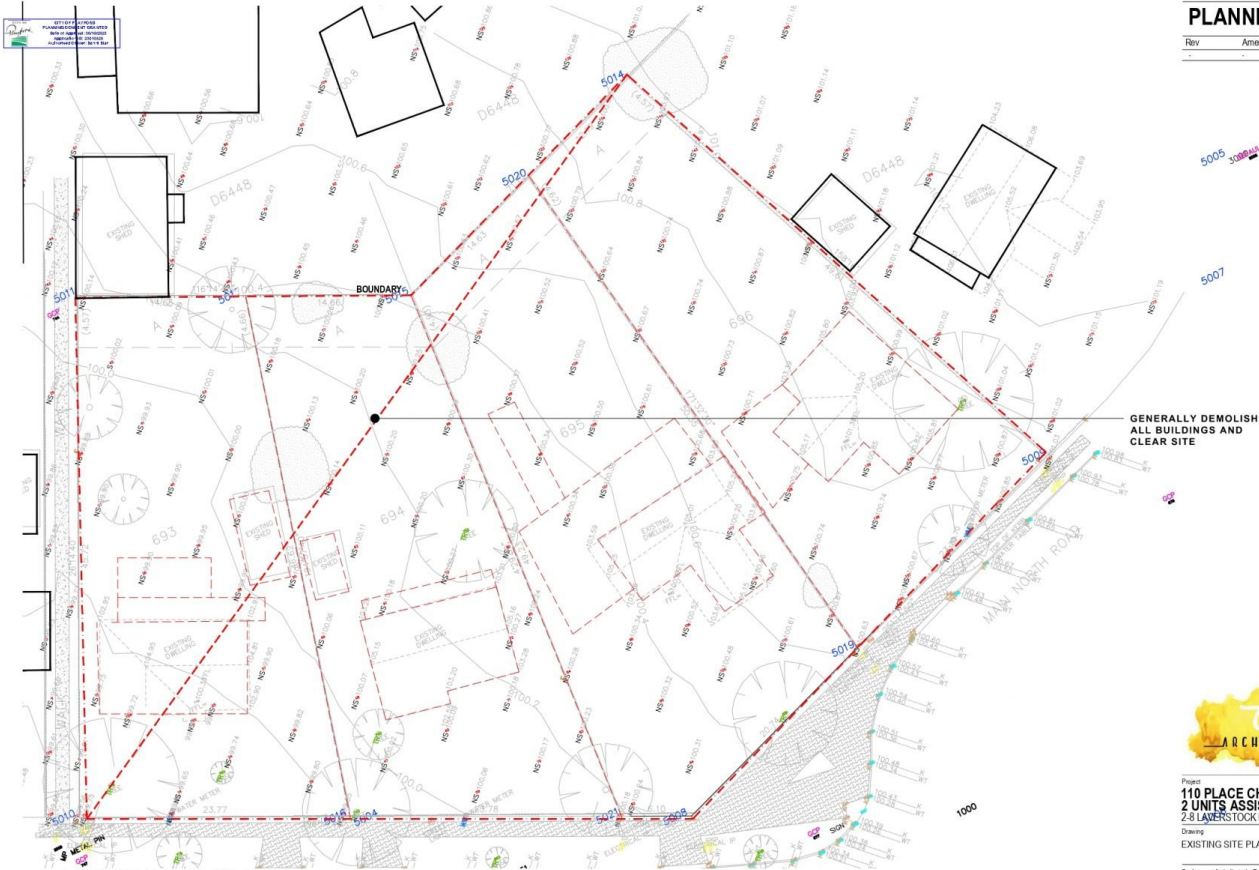

Project
**110 PLACE CHILD CARE &
2 UNITS ASSISTED LIVING**
2-8 LAVERSTOCK ROAD, ELIZABETH NORTH

Drawing
EXISTING SITE PLAN

Scale As Indicated Drawn JT
Client -
Date 2023/03/23
Job No. 202300021
Dwg No. **DA03** Rev: B A3 SHEET

EXISTING SITE PLAN
1:300